

# BRONZE SWING CHECK VALVE

PN20

Fig. DCV2042TH

## FEATURES

- Swing disc
- Integral Seat
- Threaded cap
- Threaded to BS EN 10226-1 (ISO 7)
- Applicable for Building Services, Air-Conditioning, Fire-Protection, Cold Water Plumbing, Hot Water System, General Industries.



## PRESSURE & TEMPERATURE RATINGS

Working Pressure	20Bar WOG Non-Shock 10bar Saturated Steam
Shell Test Pressure	(x1.5) 30bar Hydrostatic
Seat Test Pressure	(x1.1) 22bar Hydrostatic 5.5bar Air
Working Temperature	-10°C ... 170°C
Suitable Media	Water, Oil & Gas

## MATERIAL SPECIFICATIONS

Part	Material	Specification
Body	Bronze	EN 1982 GC CC491K
Cap	Bronze	EN 1982 GC CC491K
Disc	Bronze	EN 1982 GC CC491K
Hinge	Brass	EN 12165 CW617N
Hinge Pin	Stainless Steel 420	EN 10088-3 1.4021
Hinge Nut	Brass	EN 12165 CW617N
Gasket	Non-Asbestos	

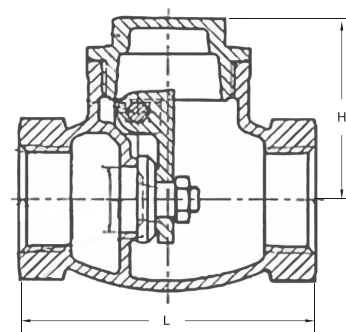

## DIMENSIONS

		(mm)					
DN	(mm)	15	20	25	32	40	50
	(inch)	½	¾	1	1¼	1½	2
L		58	66	76	88	96	112
H		37	43	49	57.5	63	72